

PressLine INC

**Ryobi 2800, 3200, 3302M, Parts and
Accessories Catalog**

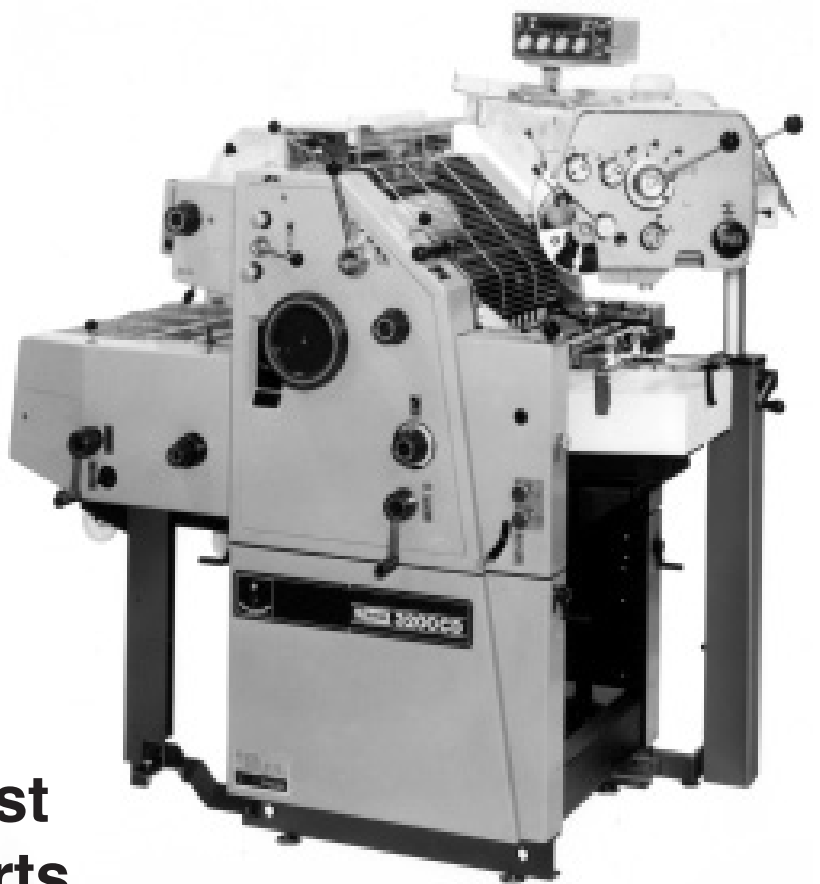

**Ryobi Parts
Order Online
Or Phone
Check are website
Ryobi press parts list
for sale prices & parts
in stock New &
Used Buy Now
Pay Pal**

**Pressline Printing Equipment Inc.
This website has only sample of our
total inventory of over 5000 different
items & parts in stock if you don't see
it just E-mail presslineonline@gmail.com
or Just Call 360-674-2009**

Website www.presslineonline.com

E-mail presslineonline@gmail.com

PAYMENT (Master Card - Visa) Phone 360-674-2009

Preferred Payment (PAY - PAL)

All Information Is Believe To Be Correct But No Guarantee Is Given.

Copyright 1990 Printed In U.S.A.

ORDER INFORMATION

**50 STATES & CANADA
NORTH WEST (WASH)**

360-674-2009

**EAST COAST (EAST)
CHICAGO (CENTRAL STD)
PACIFIC STD TIME)**

**11 AM- 8 PM
9 AM - 6 PM
8 AM - 5 PM**

E-mail

presslineonline@gmail.com

Preface

All OEM part numbers contained in this catalog are to be used as reference only, in this catalog solely for the purposes of clarity. We have assembled this catalog to the best of our ability. We cannot assume responsibility for errors.

We do however, welcome your suggestions.

Telephone & Fax Orders: 95% OF ORDERS SHIPPED WITHIN 8 HOURS AFTER RECEIPT OF ORDER & PAYMENT: Company check, money order, credit card or cashiers check must accompany order for immediate shipment. Personal checks will be held for 4 weeks or until the check clears. COD Orders are sent UPS and have a UPS charge.

GOVERNMENT AND PUBLIC INSTITUTIONS; public institutions may use purchase Order numbers and will be billed. Accordingly freight and a handling charge will be added to the invoice.TM

GUARANTEE; (Videos & Electrical Parts) there no returns, for credits or replacement We will honor the original manufacturer's warranty under the terms and conditions provided by the manufacturer.

RETURNED ITEMS; No returns after 30 days, Returns are for credit or replacement only. All items are subject to a 30% restocking charge all returned items will be inspected before credit can be issued, We do not pay the freight on returned items,

SPECIAL ORDER ITEMS; require a 50% deposit when order is placed, on Non Stocking Parts Deposit can not be returned.

SHIPPING; By UPS TO 50 States, Am. Orders go UPS Reg, UPS surface freight, and UPS air freight. If the package is under 130 lbs., it can be sent UPS Red: Next Day, Blue: Two Day, Orange: Three Day.

SHIPPING CHARGE, Includes, packaging & handling charge.

PRICES; We make every attempt to keep prices firm until the next catalog.

MISTAKES. Pressline cannot be responsible for pricing or other errors, and reserves the right to cancel orders arising from such errors.

HOWEVER prices are subject to change without notice.

Tax; We are not authorized to collect tax for out-of-state orders.

THANK YOU FOR YOUR BUSINESS.

PAYMENT Master Card • Visa • Phone 360-674-2009 (Preferred PAY-PAL)

USED RYOBI PARTS

Older Ryobi Hard to Fine Parts we Have Used
Parts at half the Price.

Ryobi Press Lamp

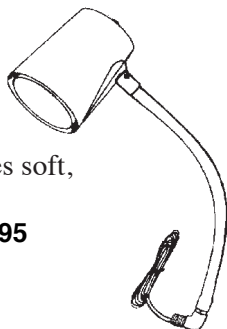

Steel wrapped flexible arm provides soft, comfortable light on work area.

95211.Lamp \$..... **149.95**

Tip Press static can because
Light switch being wired wrong
Red wire on negative white
wire on positive.

QUOTE

There is always something to be thankful for If you cannot pay your bills, you can be thankful you're not one of your creditors

INK ROLLER KITS

For Great saving and convenience, Order a single Kit

Receive all the soft Rubber Rollers needed.

AB Dick

360-8800	A-360-K 5 Rollers		\$236
360-PRO	A-360-PK	7 Rollers	\$316.73
375-9800	A-375-K	5 Rollers	\$258.85
375-9800PRO	A-375-PK	5 Rollers	\$345.45

Chief

15	C-15-K	6 Rollers	\$309.45
17	C-17-K	6 Rollers	\$329.95
215 both units	C-215-K	10 Rollers	\$550.55
217 both units	C-217-K	10 Rollers	\$579.45

Multilith

1250 10x15	M-1250-k	6 Rollers	\$239.45
1250W	M-1250W-K	6 Rollers	\$255.75
1250LW 11X17	M-1250LW-K	6 Rollers	\$

Ryobi Rollers

2800-960	R-960-K	5- Rollers	\$279.50
3200-975	R-3200	5- Rollers	\$263.50
3200-975 PRO	R-3200-K	5- Rollers	\$303.50
3302M	R-3985-PK	9-Rollers	\$565.95
400K- 500K	R-500-K	8- Rollers	\$553.95

Hamada

600K	H-600-K	5- Rollers	\$275.00
700K	H-700-K	5- Rollers	\$347.95

FEED ROLLER ASSEMBLY

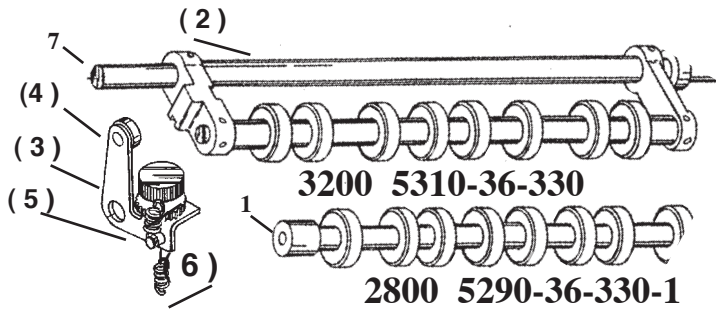

RYOBI 2800, 3200 & 3200MCD FEED ROLLER ASSY

(1)	RY-3200-8	Upper Feed Roller LOR	\$210.95
(2)	5310-36-310	Upper Feed Roller Arm Assy	\$310.00
(3)	5290-36-340	Lever	\$24.95
(4)	5290-90-202	Ball Bearing 607ZZ	\$15.55
(5)	5290-33-514-1	Spring Lever	\$7.55
(6)	5290-36-355-1	Spring	\$3.25
(7)	5290-36-36-321	Pin	\$6.00

RYOBI 2700 & 2800 FEED ROLLER ASSY

(1)	28-008	Upper Feed Roller LOR	\$156.95
(2)	5310-36-310	Upper Feed Roller Arm Assy	\$321.55
(3)	5290-36-340	Lever	\$24.95
(4)	90200	Ball Bearing 607ZZ 16	\$15.55
(5)	5290-33-514-1	Spring Lever	\$7.55
(6)	5290-36-355-1	Spring	\$3.25
(7)	5290-36-321	Pin	\$6.00

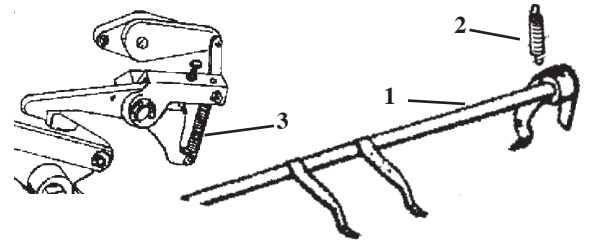

Ryobi 3200 Feeler Finger Assy

(1)	5310-21-200	3200 Feeler Finger Assy	\$232.20
-----	-------------	-------------------------	----------

Ryobi 2800 Feeler Finger Assy

(1)	5290-21-200	2800 Feeler Finger Assy	\$139.10
(2)	5290-21-162	Spring	\$3.00
(3)	5290-21-319	Spring	\$3.00

Back & Side Paper Spring

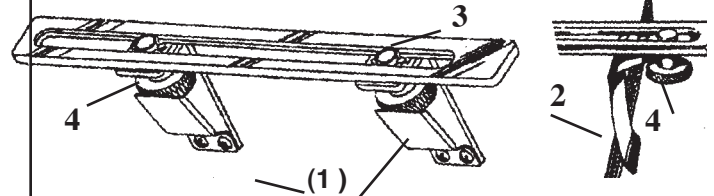

(1)	5290-32-313	Side Spring	\$11.25
(2)	5290-32-214	Back Spring	\$10.65
(3)	5290-32-215	Slide Bolt	\$4.20
(4)	5290-32-216	Knob	\$9.55

Paper Back Stop
Allows removal of top sheets
Spring loaded Back Stop

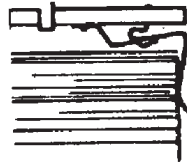

F- 553 \$

2800 & 3200 Ryobi Blanket Cylinder

5290-24-252	Nut (1)	\$32.00
(2) 5290-24-240	Knob Assy	\$90.85
(2) 5320-24-240	Knob Assy 17 1/3 Image	\$90.85
(3) 5290-24-251	Spring	\$8.35
(3) 5290-24-251	Spring 17 1/3 Image	\$8.30
(4) 5290-24-253	Nut	\$32.00
(5) 5290-24-212	Holder 2800	\$351.95
(5) 5320-24-322	Holder 3200 17 1/3 Image	\$199.95

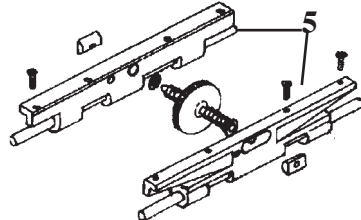
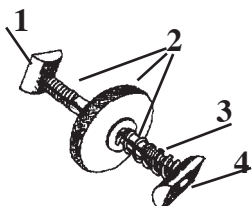

ADJUSTING CLAMP

1 (OS) Old Style Side Plate Thickness 5mm
(NS) New Style Side Plate Thickness 6.5mm



(1)	5290-32-211-2	Clamp (OS) 5.5mm	\$106.90
(1)	5290-32-211	Clamp (NS) 7mm	\$26.25
(2)	5290-32-217	Knob	\$4.25
(3)	5290-32-212-3	5 mm Side Plate (OS)	\$110.00
(3)	5290-32-212-1	6.5 mm Side Plate (NS)	\$65.25

(3)	R-32-212-5	5mm Side Plate (OS)	\$
(3)	R-32212-6.5	6.5mm Side Plate (NS)	\$

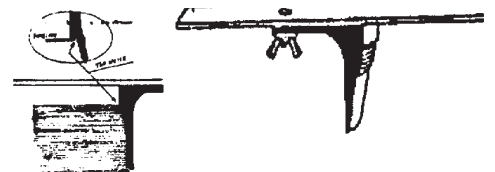

IMPROVED!

These backstops are made of heavy anodized aluminum. No installation needed. Just unclamp the regular Back Stop and install the Wizer Backstop in its place and run Envelopes at TOP SPEED without misfeed.

F-550 Time Saver \$ 27.00



Seeking concept

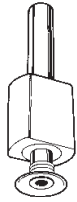

A spring-loaded vacuum controlled piston (just like the Big Boys). Big Foot retracts and stays that way till the sheet is in-fed, then goes for the next one and you get perfect separation every time using Big Foot and Big Foot uses AB Dick rubber suckers. Available for other PRINTING presses.



SUCKER

- R- 371-1 (Set of 1)\$
- R -371-4 (Set of 4)\$
- R-371-11 (Set of 11 Ryobi).....\$
- R-371-14 (Set of 14 Ryobi).....\$
- **Big Foot Suckers**
- F-700 1 DZ/ Sucker Reg\$
- F-700-3 3 Dz/ Reg Sucker.....\$
- F-700-T 1 DZ/ Sucker Extra Thick \$
- F-700-T 3 Dz Sucker Extra Thick\$

Tip: Big Foot uses Half the vacuum Ryobi sucker require so If your Air Pump is weak it would pay to try the big foot. Ryobi vacuum pump page 14

Reaches down **TIP** Lost Vacuum look at Parts on Page 14



Ryobi Rubber Sucker

2800 / 3200 / 3302M

500N / 500K/

- Ryobi Standard Rubber Sucker OEM
5290-33 314 (1 Dozen) \$10.90

- Pressline Ryobi Standard Rubber Sucker
After Market Premium - for all Stock (Blue
R-7131-5 (1 Dozen) \$6.00

- After Market Ryobi Thick Black Rubber Sucker
Thick Sucker for Card stock amazing grip

R-5219-12 (1 Dozen Heavy) \$4.50

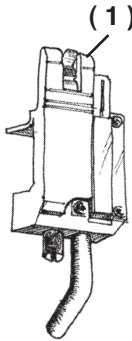

Air Sheet Separator Bracket

- 3. 5290-32-420 Air Bracket OP Left.....\$122.00
- 3 5290-32-430 Air Bracket NP Right.....\$122.00

Sheet Separator

From Ryobi Sheet Separators

2800 / 3200 / 3302M, 500N / 500K/
5290-32-451 (10) \$28.00



* After Market Ryobi Sheet Separators

2800 / 3200 / 3302M / 500N / 500K/

R-27114 Thick Brass for Envelopes & Card Stock
(1 Dozen) \$15.00

R-71409-B Thin Copper (1 Dozen) \$24.00

AB DICK SUCKER ON A RYOB

NEW RYOB SUCKER TUBES

USING AB DICK SUCKER

- 1. R-488-13 Tubes Set of 13 \$
- 1. R-488-11 Tubes Set of 11 \$

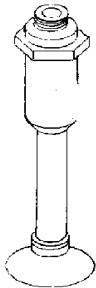

Ryobi SUCKER

You will need to set-up your Ryobi Feeder and Adjust the vacuum to using a larger sucker that uses less vacuum.

STANDARD RYOB SUCKER TUBES.

From Ryobi

- 1. 5290-33-311 Tubes Set of 1 \$13.80
- 2. 5290-33-313 Knob.....\$10.70
- 3. 90500 O-ring.....\$.075
- 4. 90600 CE -Ring.....\$0.75



- Tech Tip The Ryobi Press feeds 20lb & light Weight paper. Better when you do not use sucker.

New Improved Size and Looks • No More Air Leakage

These spring Loaded Suckers are invaluable aids to feeding curled stock, wavy stock, envelopes, NCR paper, or anything else that your regular suckers can't handle. They reach the **low spots** and ride on the **high spots**. When running tissue or light-weight stock,

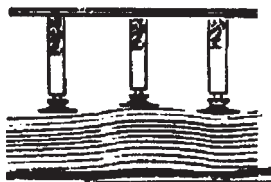

AB DICK SUCKER



- R-487-14 (Set of 13 Ryobi)\$
- R-487-11 (Set of 11 Ryobi).....\$
- R-487-4 (Set of 4)\$
- R-487-1 (Set of 1)\$
- **Compensating Suckers**
- R-700 1 DZ/ Sucker Reg\$
- R-700-3 3 Dz/ Reg Sucker\$
- R-700-T 1 DZ/ Sucker Extra Thick \$
- R-700-T 3 Dz Extra Thick Sucker.....\$

This Place Requires no physical fitness program Everyone gets enough exercise jumping to conclusions.

QUOTE: Let's put it off till Tomorrow after all we got away with it yesterday

Paper Height Control Bar Feed Lever

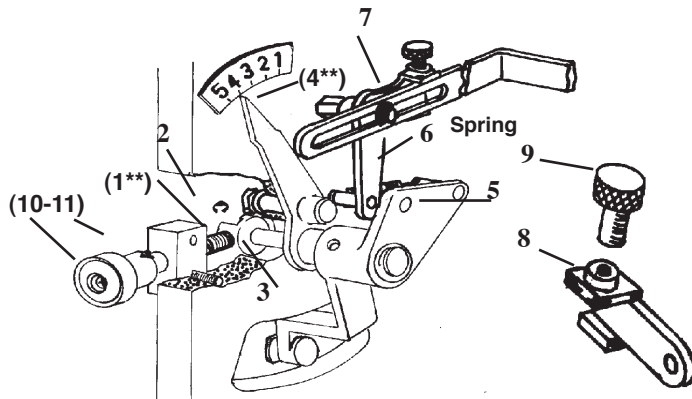

- | | |
|----------------------------------|---------|
| (1) 5300-38-234-1 (Feed Screw) | \$17.25 |
| (2) 9721-07-0008 E-Ring E-7) | \$0.75 |
| (3) 5290-38-232 Joint | \$12.85 |
| (4) 5290-38-220 Indicator | \$46.45 |
| (5) 5290-38-210-1 Lever | \$89.95 |
| (6) 5290-38-322-1 Spring | \$2.25 |
| (7) 5290-38-310-1 Lever | \$34.50 |
| (8) 5290-38-330 Lever | \$25.75 |
| (9) 520-32-452 Knob | \$5.60 |
| (10) 9650-05-2014 Screw M5X20 | \$0.75 |
| (11) 5290-38-236 Knob | \$25.75 |

IMPRESSION CONTROL ON MORE LITE PRINTING

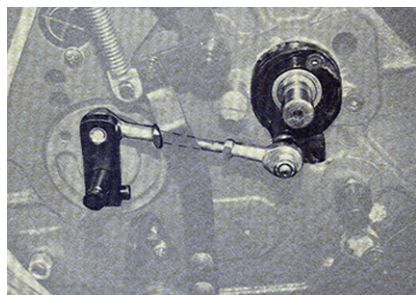

Impression Control is a retrofit kit that rigidly supports the impression cylinder. The Arms now supporting the cylinder are replaced with frame supported adjustable eccentric. The Pressure Adjustment knob is retained, but now the Over-All Pressure Control is accurate-on guess work. This Improvement now permits an accurate and full transfer of dot or solid from the blanket to a textured, linen or coarse stock. And Using Less Ink.

IMPRESSION CONTROL

Ryobi Impression Springs do go bad factory setting on the impression is 45 mm sometimes a couple turns on the nut we'll give the impression little more tension.

Ryobi 2800 & 3200 Side Frame

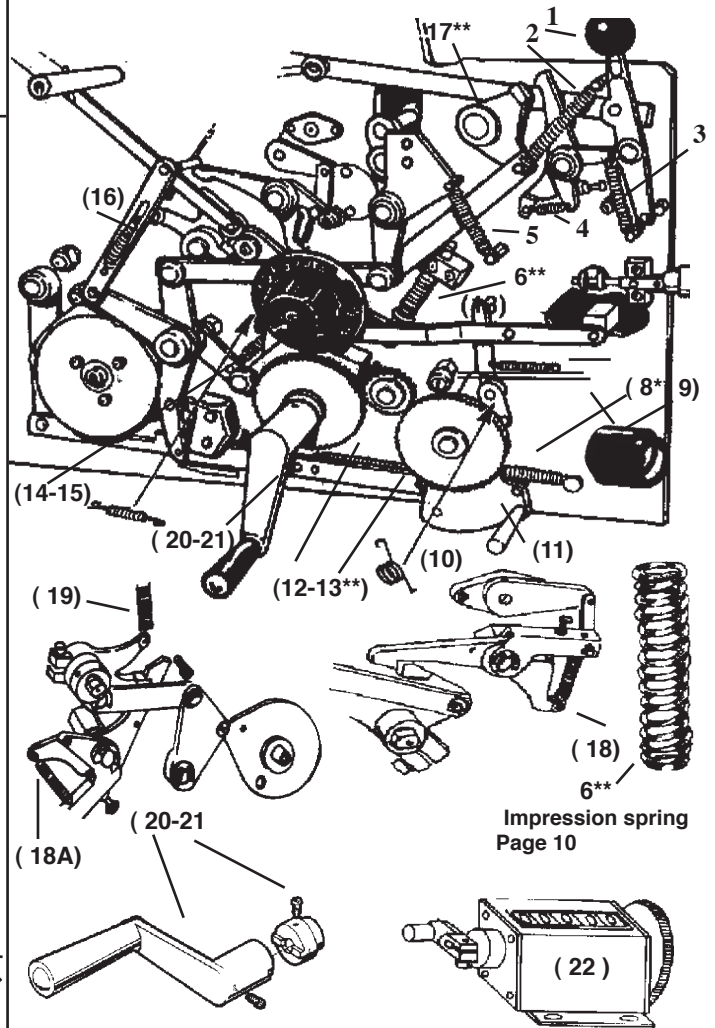

- | | | | |
|------|---------------|---------------------------|----------|
| 1. | R-90758 | Ball Black | \$6.65 |
| 2. | 5290-21-643 | Spring..... | \$3.25 |
| 4. | 5290-21-521 | Spring..... | \$11.75 |
| 5. | 5290-21-143-1 | Spring..... | \$11.75 |
| 6. | 5330-22-221 | Ryobi Pressure Spring ... | \$17.25 |
| 6. | R-22-221-H | Heavy Pressure Spring . | \$15.65 |
| 7. | 5290-37-434 | Spring..... | \$4.00 |
| 8. | 5290-21-164 | Rubber stopper | \$4.50 |
| 9. | 5290-37-233 | Springs | \$26.75 |
| 10. | 5290-37-251 | Pawl Spring..... | \$4.65 |
| 10 | 5290-37-240-1 | Pawl | \$44.95 |
| 11. | 5290-37-300-1 | Ratchet Wheel Assy..... | \$330.75 |
| 12. | 5290-37-151 | Spring..... | \$3.25 |
| 13. | 5290-37-140 | Paper Feed Link..... | \$30.00 |
| 14. | 5290-21-143 | Spring..... | \$1125 |
| 15 | 5290-38-141 | Spring..... | \$4.55 |
| 16. | 5290-35-136-1 | Spring..... | \$13.75 |
| 17. | R-40-3600 | Taper Pin Assy | \$ |
| 18A. | 5290-21-521 | Spring..... | \$11,75 |
| 18. | 5290-21-319 | Spring..... | \$3.25 |
| 19. | 5290-54-542 | Spring..... | \$22.35 |
| 20. | 5300-37-810 | Handle Assy | \$226.75 |
| 21. | 5310-37-723 | Boss | \$18.85 |
| 22. | R-91000 | Counter Assy RS-204-5 | \$138.00 |

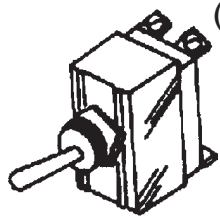

**(Drive & Pump Switch)
2800, 3200 Ryobi**

- | | | |
|----------|---------------------------|---------|
| 1. 97400 | Drive Motor Switch WD1121 | \$53.10 |
| 2. 95171 | Air Pump Switch WD1122 | \$35.95 |

Impression Spring

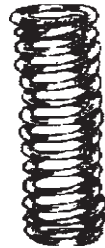
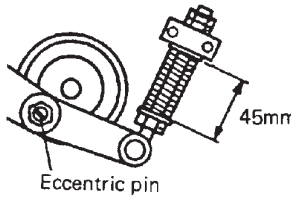

IF Your Ryobi is having bad Impression problem
Our Extra Heavy Impression Spring Can Help
Especially if your Press is 3 years old or a
3200 Ryobi or the new Ryobi 3200E
Maxima Impression Kit
SOLUTION: Greater impression allows you to
transfer 100% of image to textured stock, use less ink,
get a sharper image and maintain ink/ water balance.

- | | | |
|-------------|--------------------------------|--------|
| 5290-22-221 | Ryobi Pressure Spring Set of 2 | \$7.95 |
| 22-221-H | Heavy Presser Spring Set of 2 | \$7.95 |

Tip: Bad Impression
IF Your Ryobi has Bad Impression and is
printing light, Read what we have to say.
Order our Tip Sheet.

Cylinder Pressure Shaft & Impression Arms

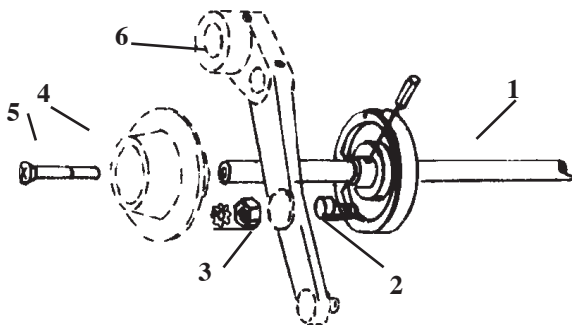

- | | | |
|------------------|---------------------|---------------|
| 1. 5310-22-300 | 3200 Ryobi Arm Assy |\$586.50 |
| 1. 5290-22-300-1 | 2800 Ryobi Arm Assy |\$286.50 |
| 2. 5290-22-142 | (OP) Eccentric Pin |\$29.95 |
| 2. 5290-22-141 | (NO) Eccentric Pin |\$13.36 |
| 3. 9660100014 | Lock Washer M 10 |\$.075 |
| 5. 5310-22-313 | Dial Knob Black |\$30.85 |
| 6. 5290-22-161 | IMP Bushing | \$23.75 |
| 7. 5290-22-150 | Impression Arm Assy |\$268.95 |

Tip: IF the Eccentric Pin is not set right you will not
have Fixed impression.

Hand wheel & Crank

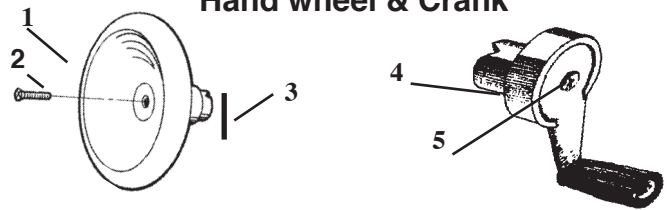

- | | | |
|------------------|-------------------|----------|
| 1. 5306-25-116-1 | Hand wheel | \$275.25 |
| 2. 5290-22-318 | Screw | \$0.75 |
| 3. 9410402508 | Spring Pin 4 X 25 | \$1.00 |
| 4. 5300-12-220-1 | Crank Assy | \$80.00 |
| 5. 9650052014 | Screw 5 x 20 mm | \$1.00 |

Suction Drive Arm Assembly



- | | | |
|------------------|---------------------|----------|
| 1. 5310-33-210-1 | 3200 Ryobi Arm Assy | \$567.25 |
| 2. 5290-33-210 | 2800 Ryobi Arm Assy | \$369.00 |

Tip: When the taper pin is bad the feed lever
will be loose on the Suction bar and will cause mis-
feeding.

**Feed Table Sprocket Assembly
Ryobi 2800, 3200, 3302M**



- | | | |
|-------------------|----------------------------|----------|
| (1) 5310-37-710 | 3200 & 3302M Sprocket Assy | \$264.35 |
| (1) 5290-37-710 | 2800 Table Sprocket Assy | \$389.95 |

Chain And Table Crank

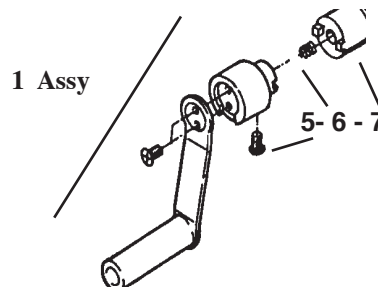

- | | | |
|------------------|------------------------|--------------|
| 1. 5300-37 810 | Paper Table Crank Assy | .\$226.55 |
| 1. 5296-88 160-1 | Chain Table Crank Assy | .\$150.00 |
| 5. 9642050514 | Screw 5x5mm |\$.075 |
| 6. 5290-37 814 | Spring |\$7.95 |
| 7. 5290-37-723 | Boss |\$18.85 |

Right Side Machine Plate

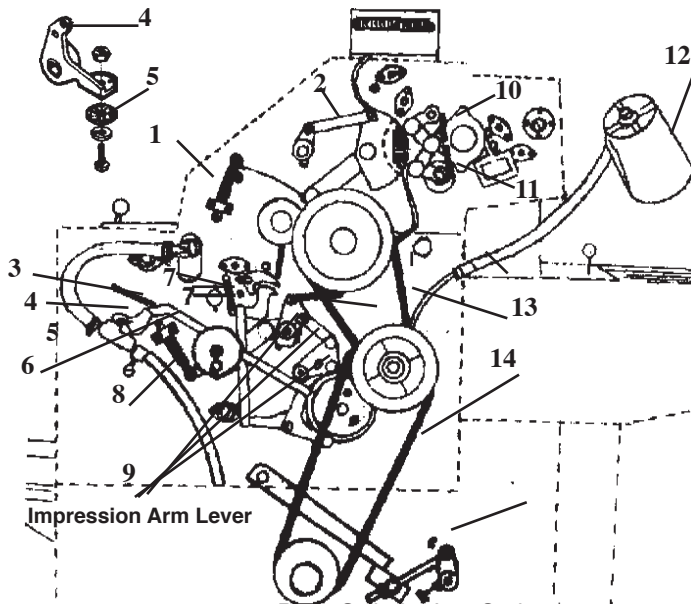

1.	5290-22-221	Plate Cylinder Imp Spring	\$ 7.95
2.	5290-52-115	Link	\$54.95
3.	5290-37-434	Spring.....	\$ 4.00
4.	5290-34-130	Lever	\$48.40
5.	5290-34-141-1	Air Packing	\$ 1.85
6.	5290-34-121	Link	\$35.70
7.	5290-21-143-1	Spring.....	\$11.08
8.	5330-22-221	Imp Pressure Spring	\$
9.	5290-90-758	Arm Pressure Spring	\$
10.	5290-51-123	Spring Form Roller.....	\$ 5.35
11.	5290-52-119	Spring Form Roller.....	\$ 4.20
12.	95211	Lamp Assy	\$149.90
13.	90100	V-belt 30"	\$10.60
14.	90104	V-belt 40"	\$11.90

When the E-Ring is off the Speed screw loose its speed Adjustment.

LOW VACUUM

Tip: 4-5-6 Is the first place I look for LOW VACUUM, Parts worn-out can cause vacuum lost Number 5 Air Packing can cause up to 50% lost in Vacuum, And not put on the Lever (4) Right will cause Vacuum Loss Be patient when replacing this part.

Impression Arm Lever

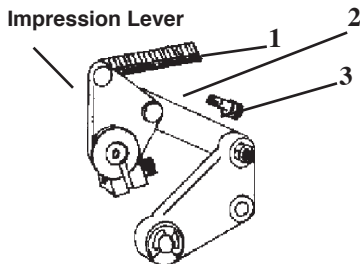

Eccentric
Screw
Adjustment for

1.	5290-21642-2	Spring	\$ 3.10
2.	5290-21-622	Link	\$34.95
3.	5290-21-623-1	Eccentric Screw	\$22.50

Drive Shaft 2800. 3200.

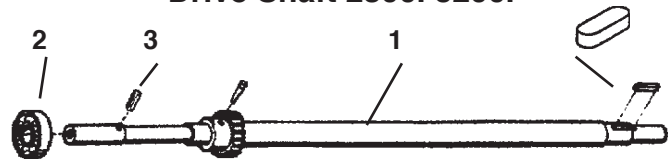

1.	5310-25-110	3200 Drive Shaft & Gear	\$374.50
1.	5290-25110	2800 Drive Shaft & Gear	\$310.25
2.	90207	Bearing 6203LLB	\$9.50
3.	9410402508	Spring Pin 4x25mm	\$1.00
6.	90900	Key 5x5x16	\$2.50

Ryobi 3200, 2800 Drive Belts & Variable Speed Pulley

Pulley Variable Speed Pulley

5290-15-200-1

\$239.95

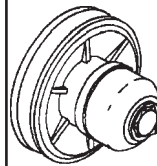

DRIVE CLUTCH PULLEY ASSY

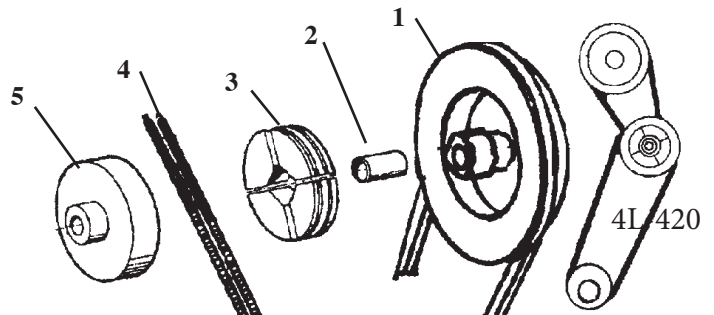

1.	5290-15-200-1	Drive Pulley	\$235.95
2.	5290-25-216	Collar.....	\$11.40
3.	5290-25-212	Clutch Weight (4)	\$179.90
4.	5290-25-213	Spring (2)	\$22.00
5.	5290-25-211	Clutch Cover	\$96.85

Tech Tips: If your Ryobi is turning over hard with the hand wheel Number Two Bushing needs to be Cleaned & Greased, if you see wear it should be replaced.

Paper Back Stop Spring Assy 2700, 2800, 3200, 3302M

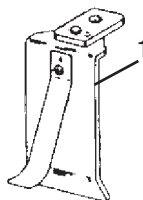

1	84660	Complete Assy	\$76.95
---	-------	---------------	---------

• Tip: Press is coming off impression this is were I look first to see if eccentric screw (3) adjustment is right it should be tight on Impression link.

• Tip: Before you remove the Impression lever use white out to mark were the lever is on the impression shaft and the high part of the cam, (On impression.) Instruction & Adjustment sheet with parts order.

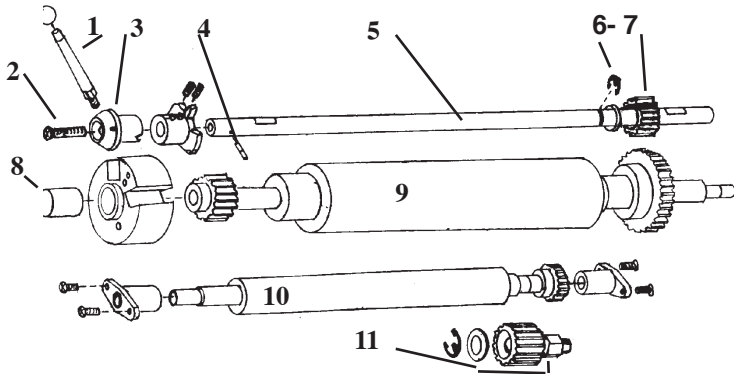

INK SECTION

0.	Kroil oil	Kano Aero kroil oil.....	\$
1.	5340-51-080	Lever Assy Black	\$37.35
2.	5290-22-318	Screw.....	\$.65
3.	5290-52-121-1	Boss.....	\$98.17
4.	9410302008	Spring Pin 3x20 mm	\$.65
5.	5320-52-111	3200 Night Latch Shaft.....	\$189.95
5.	5290-52-111-1	2800 Night Latch Shaft.....	\$179.95
6.	9662080014	Ring, M 8	\$
7.	5290-52-131-Z	Gear & Bushing	\$151.05
8.	5290-51-043	(2) Bushing	\$10.60
9.	5310-51-410	3200 Ink OSC.....	\$1,073.25
9.	5300-51-410	2800 Ink OSC	\$916.00
10.	5310-51-300	3300 First Roller	\$578.25
10.	5290-51-300	2800 First Roller	\$
11.	5290-51-321-Z	Gear, Bushing	\$87.55

• **Tech Tips:** You will need a good Oil to loosen the setscrew Kano Aero kroil is the best money you can spend when working on a Ryobi
Sold With Installation Instructions sheet.

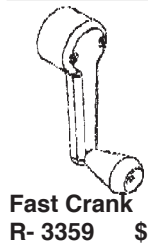

FAST OPERATION -This Fountain Crank provides a steady even turning of the ink fountain roller for quick job setups or fast recovery of ink while press is running.

MIXING OF INK - Adding and mixing of driers, varnish, reducers, etc., to ink, right in the fountain, is quick and

Fast Crank
R- 3359 \$

IDLER GEAR & Night Latch Gear & Bushing



5290-52-131-Z Gear & Bushing \$151.05

- (Tech Tips) Leaking Ink fountain (some times it works) Use a thin coating of silicon to seal the back edge of the ink blade and let dry.
- (Tech Tips) Leaking Ink fountain, the easy way would be to order the complete assembly and you will know all the parts fit tight. The problem is the ink fountain blade is not sold to fit. It is over size, and has to be Machined to fit the ink fountain you have. We recommend you do not do this in your shop but have a good machine shop do the work should not be more than one hour labor charged. The Machines will need the Ink Fountain Assembly & Ink Roller. And use a thin coating of silicon to seal the back edge of the ink blade an let dry.

New Style Ink Fountain

1.	5310-51-000-1	3200 Ink Fountain Assembly	\$1,919.27
1.	5290-51-000-2	2800 Ink Fountain Assembly	\$1,780.60
2.	5330-51-020	3200 Fountain Blade	\$ 96.20
2.	5290-51-020-1	2800 Fountain Blade	\$ 88.70
3.	5340-51-012-2	Plate (OPS)	\$ 119.95
4.	5340-51-013-2	Plate (NOP)	\$ 66.35
6.	5310-51-031-1	3200 Ink Fountain Roller	\$ 731.25
6.	5290-51-031-2	2800 Ink Fountain Roller	\$304.00
6.	5290-51-043	NOS Ink Roller bushing	\$ 10.06
7.	5310-51-090	Ink lever & one way clutch Assy	\$ 53.60
8.	90437	One way clutch FC 16	\$ 53.40
10	5290-51-070	Ink Pawl	\$ 54.95
11	5290-51-064	Pawl Spring	\$ 4.75

Old Style Ink Fountain

1.	R-50-00-32	3200 Ink Fountain Assembly	\$
1.	5290-51-000-28	2800 Ink Fountain Assembly	\$
2.	R-51-020	3200 Fountain Blade	\$
2.	5290-51-020	2800 Fountain Blade	\$
5.	5290-51-014	Ink Knob	\$10.60
6.	R-51-030-32	3200 Fountain roller Ryobi	\$
6.	5290-51-310	2800 Ryobi roller two knobs	\$ 310.15
6.	5290-51-0301-2	2800 Ryobi roller one knob.....	\$
3-4	5920-51-013	Sold Used Side Frame	\$ 88.71

(Tip)Ryobi new parts books can have old part numbers listed. Good example 3302M Parts book have the same part number for Ink fountain assembly old-style fountain is ratchet type new style Dial indicator type same part number.

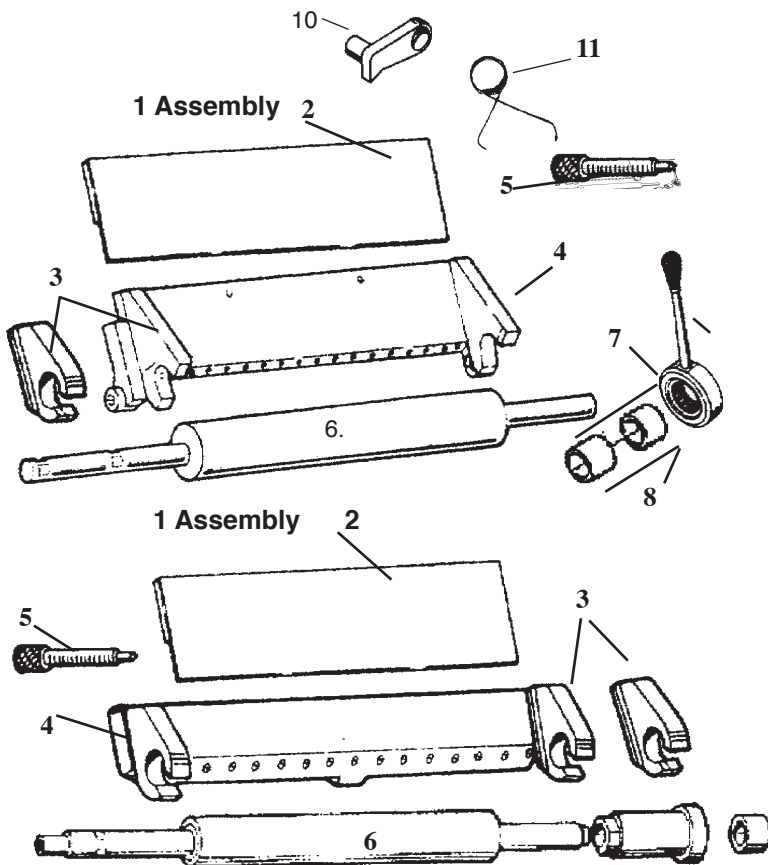

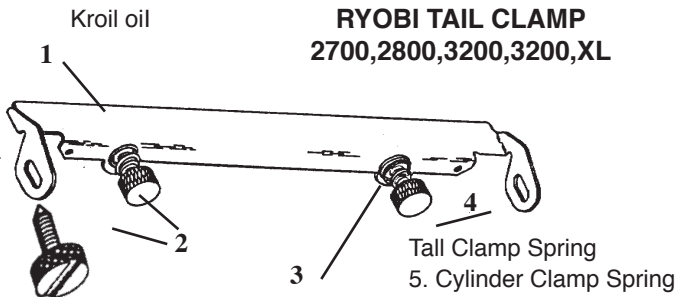

RYOBI TAIL CLAMP
2700,2800,3200,3200,XL

1.	5310-54-410	3200 Tail Clamp	\$125.10
1.	5320-54-716	3200XL Tail Clamp 17-1/4 Image	.\$
1.	5290-54-410	2800 Tail Clamp	\$113.25
1.	5290-54-760-1	2800 Tail Clamp 17-1/4 Image	\$52.00
2.	5290-54-337	Knob	\$4.95
2.	5320-54-753	Knob 17-1/4 Image	\$5.80
3.	5290-54-413	Knob Spring	\$1.10
4.	5290-52-533	Tall Clamp Spring	\$5.95
4.	5290-54-413	Tall Clamp Spring 17-1/4 Image	\$1.10
5.	5290-54-325	Cylinder Clamp Spring	\$12.85

Tech Tip: The tall clamp post is screwed in on the operator Side you will need a long screwdriver that will reach the plate cylinder to make the job easy a good Oil to loosen the set-post and our Kano Aerokroil is the best & our Spring Hook

Ink & water ductors shaft
(NEW) style ink & water ductors have a shaft which is not part of the roller

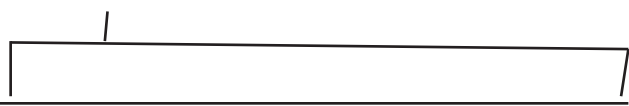

New Style Ryobi Ink Ductor Shaft

2800	5290-51-142	\$
3200	5330-51-142	\$
3200MCD	5340-51-142	\$
3302M	5340-51-142	\$
3302M & 3200MCD Water Ductor Shaft		
5340-52-342-2	Shaft	\$

Tip: Remember when removing shaft from roller, shaft will be swelled on the ends require light filing I said light filing in order to remove shaft

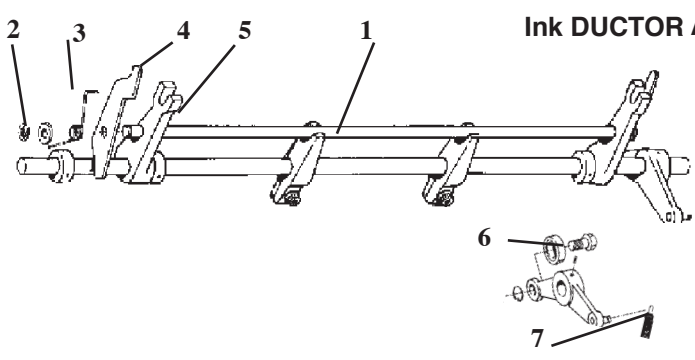

Ink DUCTOR ASSEMBLY

1.	5310-51-100-2	3200 Ink Ductor Assy \$
1.	5290-51-100-2	2800 Ink Ductor Assy.....	\$510.37
2.	9721040008	E-4 Ring	\$0.75
2.	5290-51-135	Collar	\$4.10
3.	5290-51-133	Spring (OPS)	\$4.30
3.	5290-51-134	Spring (NPS)	\$3.15
4.	5330-51-132	Latch Right & Left	\$4.95
5.	5290-51-131-2	Ink Arm Right & Left.....	\$47.00
6.	R-90200	Ball Bearing	\$3.30
7.	5290-51-123	Spring	\$5.35

Ryobi Press Washer 2800, 3200, 3200PFA, 3302M

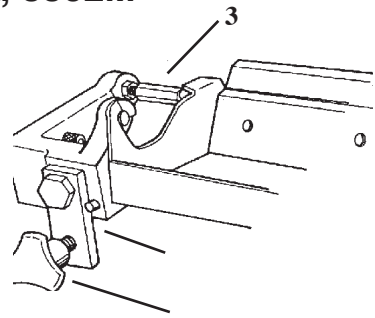
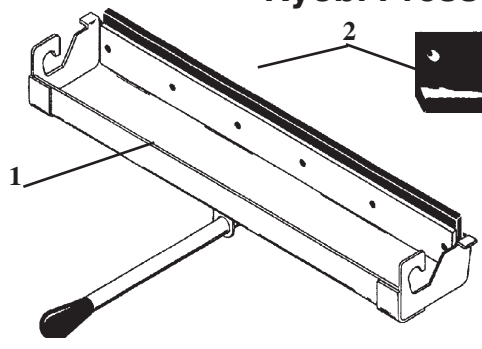

1.	5310-52-500-1	3200 Press Washer Assy	\$138.90
1.	5290-52-500-1	2800 Press Washer Assy	\$235.30
2.	5310-52-521	3200 Clean up Blade Black	\$16.00
2.	5290-52-521-2	2800 Clean up Blade	\$19.15
2.	5330-52-521	3200 PFA Clean up Blade	\$ 28.05
2.	5340-52-524-1	3302M Clean up Blade	\$29.60
3.	5290-52-533	Stud Post R - L	\$5.95

• Tech Tips: Ink Clean up unit is not cleaning up right, and you have a new clean up blade on the wash up. The first thing I check is the Ryobi Ink forms they can be adjusted for even pressure between form and main Oscillator Roller this is usually where the problem is, then check pressure between the blade and Main Oscillating Roller for even pressure. The brackets are set at factory and should not have to be adjusted.

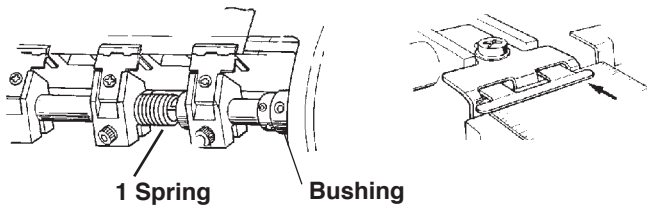

1 Spring Bushing

IMPRESSION CYLINDER BUSHING
Tip: The one bushing that never seems to get oil, Can not be check for wear unless the spring pressure is off.

IMP Bushing Set of 2
 5290-23-234 \$ 61.70



IMPRESSION SPRING

1. Impression spring Set of 2
 5290-23-236 \$ 49.90

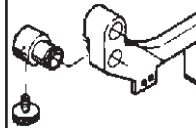

SIDE GUIDE JOGGER BUSHING

	5290-89-227-1	Bushing NPS	\$58.75
	5290-37-513-1	Bushing NPS	\$9.95
	5290-89-228	Brass Plug	\$1.00

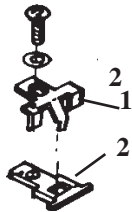

OLD STYLE GRIPPER 2700 & 2800 RYOBI

- 1. 5290-23-233-1 Stopper Old Style 6mm gripper \$9.20
- 2 5290-23-232-1 Gripper \$9.65

IMPRESSION Lever



- 1. Impression Lever & Taper Pin**
 5290-23-220 Lever \$102.95



**IMPRESSION STOPPER
 2800 & 3200**



- 1. R-23-233 Stopper New Style \$2.2
- 2 -23-2321 Gripper \$

Tip sheet with order

**CHAIN GRIPPER ADJUSTMENT TOOLS
 2800, 3200, 3302M**



The paper should be gripped by the chain grippers sufficiently and uniformly, and adjust so that all grippers uniformly, opening and closing all gripper timing is the same. A COPY OF THE RYOBI TECH TOOL. Tech sheet sold with Thickness Gauge.

R- 4455 Thickness Gauge \$

**Chains cannot be purchased separately
 Must be in a set of (2.)**

Dry lubricant an ideal lubricant for chain delivery

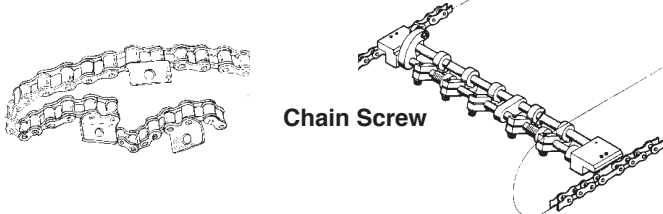

Chain Screw

**• New Style Chain 2800 & 3200, 3302M (one to one)
 Complete set with 6 Chain Link**

- 5300-87-412 R and L Chain ASSY (2) \$149.80
- 5344-87-410 3302 R and L Chain ASSY (2) \$128.40

**• OLD Style Chain 2800 (1-1/2 to 1" Star Wheel)
 Complete set of (2) with New Chain Joint Link**

GRIPPER BAR 2800, 3200,

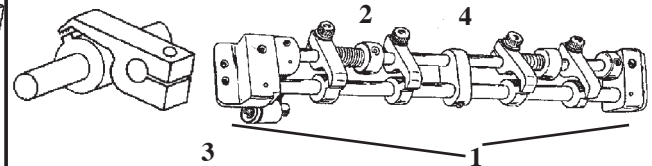

- Ryobi 2700 & 2800
- 1. 5300-87-300-2 Gripper Bar Assy \$427.90
- 1 • After Market Gripper Bar
- Ryobi 3200, 3200MCD
- 1. 5310-87-301-1 Gripper Bar Assy \$345.65
- After Market Gripper Bar
- 3302M Gripper Bar Assy
- 1. 5321-87-300-2 Gripper Bar Assy \$722.14
- Ryobi 2700, 2800, 3200, 3302M.
- 2. 5290-87-321 Gripper Spring \$3.50
- 3. 90203 Bearing \$7.00
- 4. 5290-87-322 Center Bracket \$34.25
- 5. 5290-87-318 Gripper Finger \$13.80
- 5A. 5321-87-318-2 3302 Gripper Finger Urethane \$23.45

Tip Never remove old chain from press just Fasten the new chain to the old chain and rolling Press around disconnect old chain, fasten new Chain you're have to loosen up the adjustment on the side of the press. If you need a sample for chain links don't for get to put white out on the drive gear and only remove one chain at a time.

Chain links sold set of six Using good 40 chain, US-made or Japanese made chain
 HKK Chain solid bushing rollers 40 RIV
 10FT 240 LINKS # 90853 (RF2040)
 E-Mail For price presslineonline@gmail.com

Blanket Bars

Ryobi 2800,960, 3200,975, 3302M,3985
RYOBI BLANKET BARS

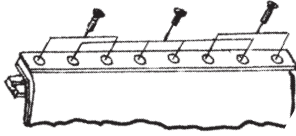

Complete Assembly With Necessary Hardware.

5300-24-230	2800 / 960 Bar Assy	\$319.00
5310-24-230	3200 / 975 Bar Assy	\$319.00
Used Blanket Bar 1/2 The Cost		

When repairing Ryobi's uses a small impact wrench to remove the screws they have a tendency of Stripping out I also spray down with KANO AERKROIL it loses the toughest screws and Allans Blanket bar removal the Allen's need to be sprayed with Kano first Better then taking a chance stripping out the Allen's.

Ryobi No-Mark Star Wheel

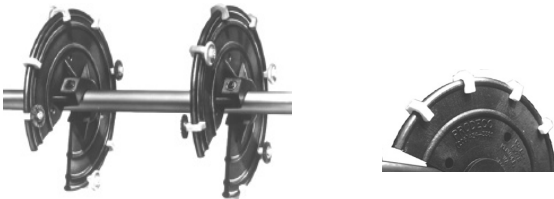

Prevents Marking and Tracking of Stock at the Delivery end.

- Fully Adjustable Tefclean Feet Let You Position for Perfection Based on Where Copy Falls on the Sheet.
- Replace, for good, those Outdated Wheels and Get Clean Copy.

Ryobi

RY-433 \$

No-Mark Star Wheel For Chain

For Presses with a 1.5 to 1" delivery.

Old Style Chain compatible. Fully adjustable to any point on the wheel for more demanding print work.

No-mark Accessories
Ryobi 2800 CD
Old Style Chain.



RY-445 No-Mark Star wheel \$

Quick Change Blanket Bars

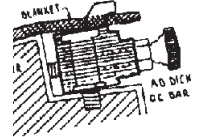
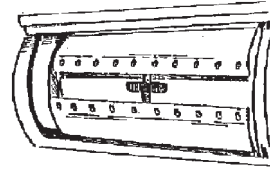

Ryobi 2800,960, 3200,975, 3302M, 3985

Change Blankets in 60 seconds.
Not an extra set. Bars remain on cylinder.
Available for; AB DICK, ITEK, RYOBI.

ORDER QUICK CHANGE BLANKET BARS

30310	2800 / 960	(Set of 2)	\$224.00
5310-24-200-1	3200 / 9751	(Set of 2)	\$224.00
R- 44-60	3302M / 3985	(Set of 2)	\$

SUPER BLUE

Now available for Your Mid Sized Job Press,
Ryobi 3200, 3302M, AB DICK 375, 9800, Itek 3985

• Developed by a Pressman

Mark-Less Super Blue is a cast aluminum cylinder with a frictionless surface covered by a loose fitting Ink and Water repellent (The Cylinder) mounts right on your Skeleton Wheel shaft, Super Blue, delivering a truly Mark-Less Sheet, Super Blue Systems.

- Deliver a True Mark-Less Sheet.
- Very Easy To Install.
- Allows You To Run Solids And Screens On Coated Stock And

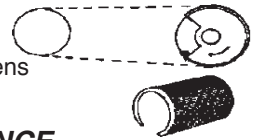

GUARANTEED PERFORMANCE

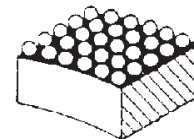
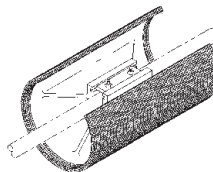

Silicon Bead

Mark free Film

Ryobi 3302M , 3200,
R- 3200 Cylinder Blue \$

Replacement Net 2-36x36 Net Trim As needed -Blue Net
R-3200 Blue-Net \$

Mark free Film For Super Blue

Not - tac Film Silicon Beaded Surface

No Mark Siliclean \$

RYOBI VACUUM PUMP 2800,3200,3302M

RYOBI VACUUM PARTS

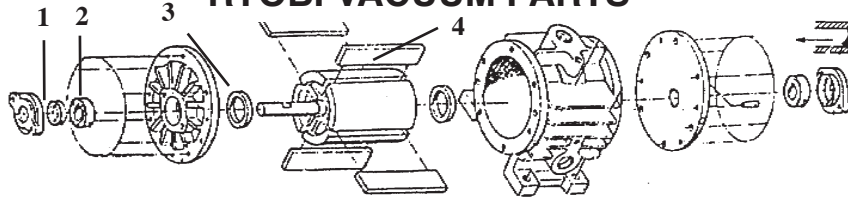

New Parts Include : 1 Felt Shaft Seal,
2 Ball bearing, 2 Ring,
4 Vane, 1 Oiler wick, 2 Air Filters

R-162003	Kit	\$
1.	90541 Seal	\$
2.	90296 Ball Bearing 6202-Z	\$10.50
3.	6237 Ring	\$
4.	5290-16-227 (4) Blades	\$76.00 ea.
5.	91150 Wick	\$1.65

Check Air hose is not plugged

REBUILT VACUUM PUMP

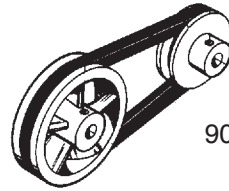
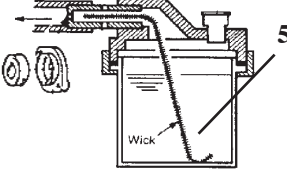

Vacuum Pump V-belt
90102 V-belt A-36.....

Check Your Air Filter

Ryobi vacuum pumps are bitch to rebuild they've made Changes on parts with the same part number a good Example is the ring they have eight different sizes, on The blades they have three different sizes only thing I Would recommend, I'm taking a chance on is the blades And new bearings of course they can't be returned if they don't work right consider. Sometimes disassemble And cleaning does the job most problems are caused by using the wrong vacuum oil.

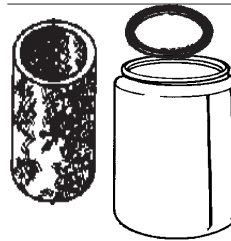

5290-16-312	Gasket	\$9.65
5290-16-311	Plastic Bottle		\$25.75
5290-16-313	Filter	\$1.90

Check Your Air Filter

I used Amsoil synthetic Compressor oil should be a dealer near you.



If you ever seen what non-synthetic oil does to oil light bushing, you know why I recommend a good synthetic oil.

A penetrating dry lubricant that protects, lubricates and disperses water. Protects all metals against rust and corrosion. Lubricates and sprays into hard-to-reach places. An ideal lubricant for Plate Clamps, water unit, gears and **Chain Delivery**. Dries wet electrical systems without harm to wiring or circuitry.
G-120 Metal Protector AMP
8 3/4 oz. Can \$



RYOBI VACUUM PUMP AIR

AIR LINE RYOBI 2800, 3200, 3302M, 500,

1.	5290-17-120	Air Terminal Plastic	\$36.00
1	5290-17-120-1	Air Terminal Cast Iron	\$45.00

Air Sheet Separator Bracket

3.	5290-32-420	Air Bracket OPS Left	\$122.00
3	5290-32-430	Air Bracket NPS Right	\$122.00

Air Sheet Separator Bracket After Market

3.	32-420	Air Bracket OPS Left	\$65.00
3	32-430	Air Bracket NPS Right	\$65.00

Sheet Separator

From Ryobi Sheet Separators
2800 / 3200 / 3302M, 500N / 500K/
5290-32-451 (12 Dozen) \$

Pressline Ryobi Sheet Separators After Market
2800 / 3200 / 3302M / 500N / 500K/

R-27114	Thick Brass for Envelopes & Card Stock	
	(1 Dozen)	\$15.00
R-71409-B	Thin Copper (1 Dozen)	\$24.00



95171	Vacuum switch WDD 1122	\$
97400	Motor switch WD 1121	\$

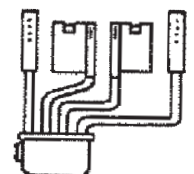
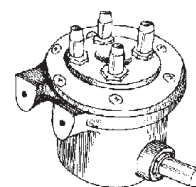
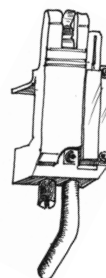
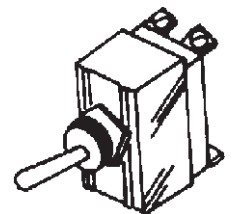

SUPER INKER FOR RYOBI

The additional distributor rollers besides giving better milling of the ink, reverse the direction of the jumbo Oscillator. This lengthens the ink train and helps to evaporate any excess water. In addition, the long steady flow of ink helps to cover starvation streaks and delivers a fine, even film of ink to the plate. The press is not altered with gadget attachments. There is no drilling or tapping for additional screws or bolts.

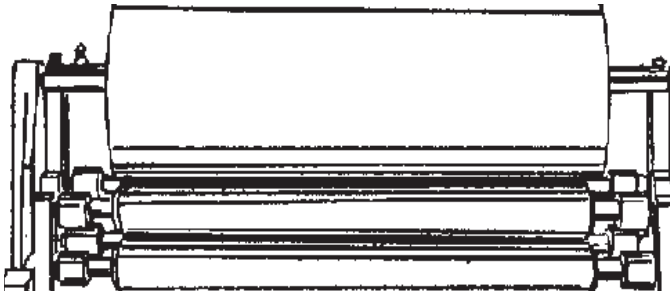

RYOBI 2800/960 SUPER INKER (ASSY) 2800 Ryobi

- R-2800 Face 11-3/4 COMPLETE SET \$500.00**
 2 28080 Ink Idler Roller Standard Size
 2 RY-2803-S Ink Idler Roller Small size
 2 RY-2850 Ink Idler Roller Brackets
 1 RY-2852-J Oscillating Jumbo Ink Roller
 Ryobi 3200
- R-3200 Face 12-7/32 COMPLETE SET (7 Piece Kit)
 32R80 Complete 7 Piece Kit \$625.00**
 2 RY-3203-A Ink Idler Roller Standard Size
 2 RY-3203-SA Ink Idler Roller Small size
 2 RY-2850 Ink Idler Roller Brackets
 1 RY-3252-JA Oscillating Jumbo Ink Roller
- R-3254-A Face 13-7/32 COMPLETE SET (7 Piece Kit
 32R80 Complete 7 Piece Kit \$**
 2 RY-3203-B Ink Idler Roller Standard Size
 2 RY-3203-SB Ink Idler Roller Small size
 2 RY-2850 Ink Idler Roller Brackets
 1 RY-3252-JB Oscillating Jumbo Ink Roller

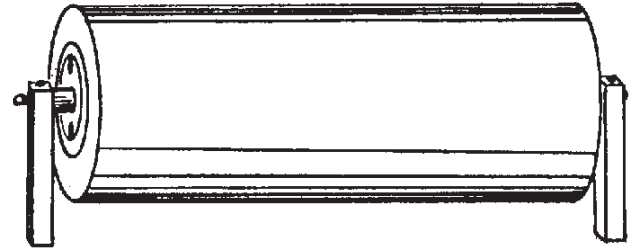

**NOTE Jumbo roll can not be used without
 Brackets and four distributor rolls.**

280840	2800 Ryobi	\$238.90
32R840	3200 Ryobi	\$325.25

RYOBI STANDARD OSCILLATING RIDER ROLLER

(Original size & Description Page)

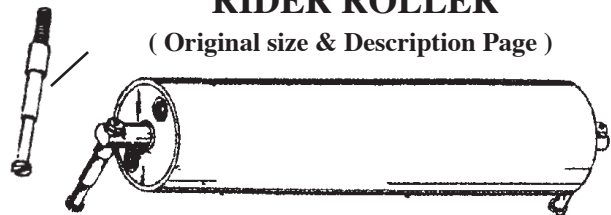

RYOBI 2800/960 INK OSCILLATING (ASSY)

- (1) 280820 Face 11-3/4 Oscillator Roller \$210.00
- 3200/375 (Old Style 12-23/32 Surface)
- (1) 32R820-A Face 12-23/32 Oscillator Roller \$808.00
- RYOBI 3200-E & MCD INK OSCILLATING**
- (1) 32R820-B Face 13-11/16 Oscillator Roller \$224.40



GEARED DISTRIBUTOR ROLLER

- Ryobi 2800**
- (1) 5276-51-300 Geared Distributor Roller \$
- Ryobi 3200 (Old Style 12-29/32 Surface)**
- (2) 5310-51-300 Geared Distributor Roller \$
- Ryobi 3200 (New Style 13-7/32 Surface)**
- (3) 5322-51-310 Geared Distributor Roller \$



GEARED MAIN OSCILLATING ROLLER (Ebonite Rubber)

- Ryobi 2800**
- (1) 5276-51-400 Geared Main OSC \$
- Ryobi 3200 (Old Style 12-29/32 Surface)**
- (2) 5310-51-400 Geared Main OSC \$
- Ryobi 3200 (New Style 13-7/32 Surface)**
- (3) 5322-51-410 Geared Main OSC \$



**INK OSCILLATING ROLLER
 BUSHING 5290-51-043 \$**

RYOBI INK ROLLER KIT. 2800/ 960/ 3200/ 975

SOFT RUBBER ROLLER KITS FOR THE RYOBI MODELS LISTED BELOW

Kit consist of 2 ink forms, 2 to 4 distributors and ductor

Ryobi MODELS 2800 - 960.
(SEE COLUMN # 1 For models 2800 & 960)
(SEE COLUMN # 2 For models 2800 - PRO)

Ryobi MODELS 3200 - 975
(SEE COLUMN # 1 For models 3200)
(SEE COLUMN # 2 For models 3200 - PRO)

All Rollers Are Guaranteed For One Year.

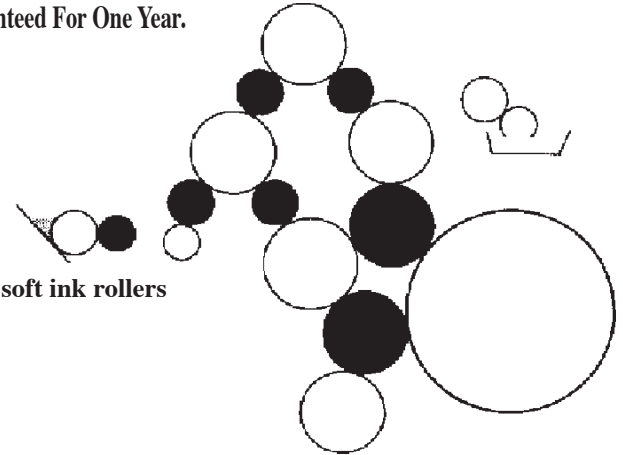
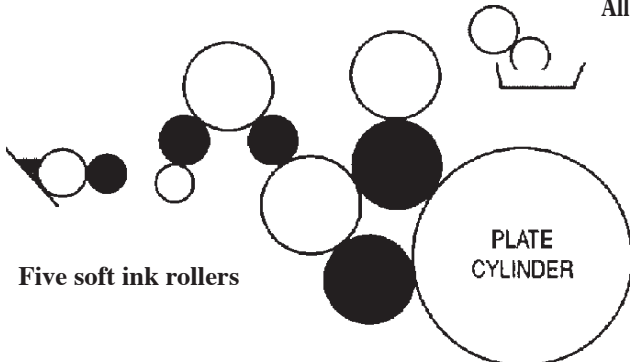

(NEW) Style ink & water ductors have a shaft which is not part of the roll and can be removed The roll has ball bearings on each end. As the roll spins in the press, the shaft does not spine with the roll.

2800 & 960 SERIES INK ROLLER KIT .

Pressline

Part No	1	2	Description	Order With Bearing New Style Ink Ductor.	Prices
OS 281-K	•		Kit five soft ink rollers (OS)	R- 960	\$259.00
NS 280-K	•		Kit five soft ink rollers (NS) Bearing	R- 960	\$275.75

3200/ 975 SERIES INK ROLLER KIT

(OS Print 12" Wide) (NS 13" Wide)

Pressline

Part No	1	2	Description	Prices
OS 320-K	•		Kit five soft ink rollers (12" W)	R- 3200 \$285.00
NS 321-K	•		Kit five soft ink rollers (NS 13" W)	R- 3200 \$297.00

RYOBI PRO INK BRIDGE KIT

PROBLEM: Inadequate ink supply to upper form roller causing ghosting and coverage problems.

SOLUTION: Bridge the two top ink oscillators with two idlers and a large ink oscillator.

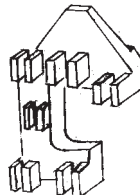

WATER OSCILLATOR ROLLER & SHELL

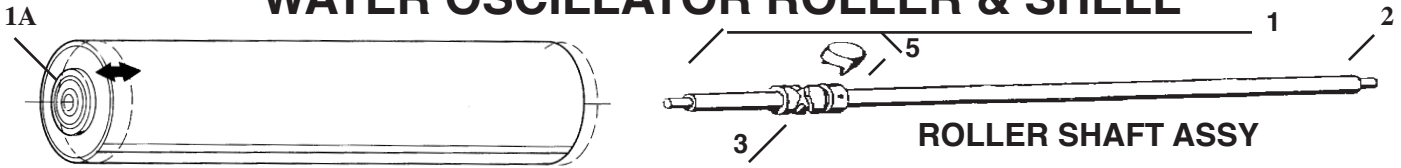

RYOBI 2800

(1)	5290-51-920-4 Shaft Assy 2800	\$
(1A)	5290-642-2 Shaft Bushing	\$
(2)	5290-51-912-2 SHAFT 2800	\$
(3A)	9410302008 Spring Pin 3X20M	\$
(5)	5290-51-940-2 Cam & Dog Assy	\$

RYOBI 3200

(1)	5310-51-920-2 Shaft Assy 3200	\$
(1A)	5290-642-2 Shaft Bushing	\$
(2)	5310-51-921-1 SHAFT 3200	\$
(3)	5290-51-940-2 Cam & Dog Assy	\$
(3A)	9410302008 Spring Pin 3X20M	\$

WATER OSCILLATOR ROLLER

SUPER AQUAMATIC ALCOHOL WATER SYSTEM

Pressline Part No	Roll Dia	Overall FACE	Length	Part No	
Ryobi 2800 / 960 ASSEMBLY					
(1) RY-2853-R	2-3/8	11-3/4	14-1/4	5290-53-320-1	\$
Ryobi 2800 / 960 SHELL					
(1) RY-28059	2-3/4	11-7/16	12-3/8	5320-53-320-1	\$

(STANDARD) AQUAMATIC WATER SYSTEM

Pressline Part No	Roll Dia	Overall FACE	Length	Part No	
Ryobi 2800 / 960 ASSEMBLY					
(1) RY-280850	2-3/8	11-1/2	14-1/2	5300-51-910-1	\$
Ryobi 3200 / 975 SHELL					
(1) RY-2853-A	2-3/8	11-3/4	14-1/2	5300-51-910	\$

SUPER AQUAMATIC ALCOHOL WATER SYSTEM

Pressline Part No	Roll Dia	Overall FACE	Length	Part No	
Ryobi 3200 / 975 ASSEMBLY					
(1) RY-3253-R	2-3/8	12-9/16	16-5/8	5320-53-310-1	\$
Ryobi 3200 / 975 SHELL					
(1) RY-32R59	2-3/4	12-1/2	12-19/32	5320-53-320-1	\$

(STANDARD) AQUAMATIC WATER SYSTEM

Pressline Part No	Roll Dia	Overall FACE	Length	Part No	
Ryobi 3200 / 975 ASSEMBLY					
(1) RY-32R850	2-1/2	12-9/16	16-5/8	5310-51-900-1	\$
Ryobi 3200 / 975 SHELL					
(1) RY-3253-A	2-3/8	12-9/16	16-5/8	5310-51-9001	\$

Ink & water ductors shaft
 (NEW) style ink & water ductors have a shaft which is not part of the roller

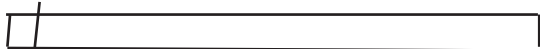

New Style Ryobi Ink Ductor Shaft

2800	5290-51-142	\$
3200	5330-51-142	\$
3200MCD	5340-51-142	\$
3302M	5340-51-142	\$

Tip: Remember when removing shaft from roller shaft will be swelled on the ends require light filing I said light filing in order for shaft to be removed from roller.

SPRING HOOK

The one thing you need when your working on an Ryobi

SPRING HOOK

Have your Walmart girl pick you up a spring hook in the knitting section

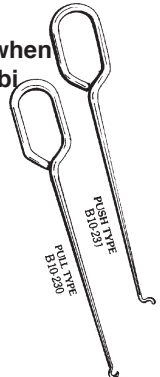
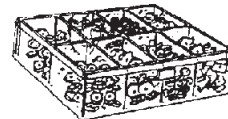

Spring Repair Kit For
 2700, 2800, 3200,
 Ryobi (28) Spring

Pressline has a good stock of used water unit parts, from presses we put Varn Kompac & Crestline Dampener units on new Printing Presses. Ryobi 2800,3200,3302M 3302H 50% Off list

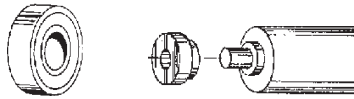

Ryobi Fountain Roller Parts
 90201 Bearing 609 VV \$20.25
 5290-53-162-2 Holder \$71.60

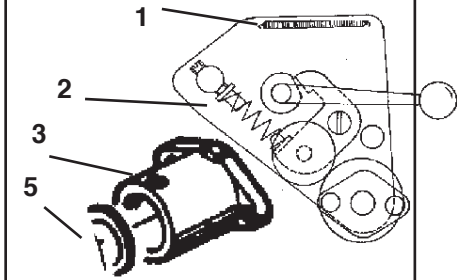

Ryobi Water Roller Parts
Tip: Springs Might Look Good But Can cause Problems.
 (1) 5290-37-434 Spring \$4.00
 (2) 5290-53-175 Spring \$4.85
 (3) 5290-29-220 Bushing \$35.65
Tip: Washer used to tighten up side play on water unit.
 9710080008 Washer \$0.75

RYOBI Water Fountain Hose
 5290-53-195 \$3.25



SUPER AQUAMATIC WATER SYSTEM 2800 & 3200

Alcohol Dampener.

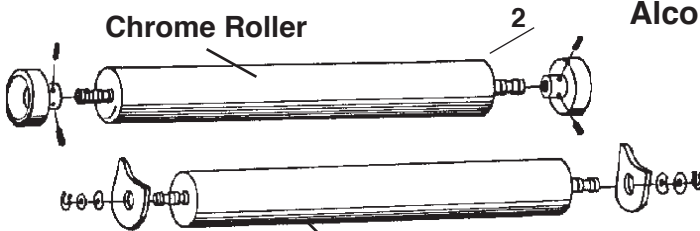

Parts Page 22



1 After Market LOR Ryobi Fountain Roller (Soft Rubber)

Pressline Part No	Roll Dia	Overall FACE	Length	Part No	
Ryobi 2800 / 960					
(1) 28055	1-7/8	11-13/16	17-23/32	5290-53-3201	\$252.25
Ryobi 3200 / 975					
(1) 32R55	1-7/16	13-7/32	19-7/8	5320-53-350-1	\$220.00

Chrome Roller Super Aquamatic Water Ductor Alcohol Dampener.

Pressline Part No	Roll Dia	Overall FACE	Part Length	No	
Ryobi 2800 / 960					
(2) 5290-53-341 Chrome	1-1/2	11-11/16	13-13/16	76641	\$ 758.00
Ryobi 3200 / 975					
(2) 5320-53-341 Chrome					\$851.00

Tip: You will need to order washer to tighten up side to side play on water unit (5)

Super Aquamatic Alcohol Dampener. Water Parts Ryobi 2800 & 3200.

(1)	(1)	5290-53-352	Shield (Set of Two)	\$3.25 ea.
	(2)	90201	Bearing Ea.	\$20.25
	(4)	529-53-161-3	Gear Housing	\$122.65
	(5)	43121	Washer (Set of 4)	\$1.25
			To tighten up side to side play on water unit	

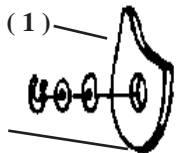

Tip Installing New Water Roller on Side Frame, align on paper cutter bed and tighten tie bar bolts. The frame must set flat on the cutter bed with no rocking. Not set right dampening unit will tone average of ever third sheet.

To Check that the water unit is set right. Plate must not ink up in the off position.

Tip: Plate must ink up even on right and left side of the plate ink line. Must be one inch on the right & left side of the plate. And clean up evenly from the center out.

RYOBI STANDARD AQUAMAGIC WATER SYSTEM

Ryobi 2800, 3200/ Itek 960, 975.



Ryobi Fountain Roller

Pressline Part No	Roll	Roll	Overall	Part	
Ryobi 2800/ 960	Dia	FACE	Length	No	
(1) 5290-53-151-3	1-3/8	12-1/4	13-5/16	5290-53-151-3	\$537.75
Ryobi Roller Only 3200./ 975					
(1) 5310-53-151	1-7/16	12-1/4	13-5/16		\$417.75

Ryobi Water Ductor Roller (Soft Rubber)

Pressline Part No	Roll	Roll	Overall	Part	
Ryobi 2800/ 960	Dia	FACE	Length	No	
(2) 28050	1-3/8	12-3/32	13-1/4	5290-53-160-4	\$65.00
(2) 32R51					\$68.40

We Have Used Ryobi Water Parts & Rollers at 50% off will in stock.

RYOBI STANDARD WATER PARTS.

2800/3200/960/975.

(1)	90201	Bearing	\$20.25
(3)	5290-25-316-1	Gear Housing	\$
(4)	5290-53-162-2	Housing	\$71.65
(5)	5290-53-153-2	Water Drive Gear	\$1
(6)	5290-53-232-1	Spring	\$119.95
(7)	5290-53-175	Spring	\$4.85
(8)	5290-29-220-1	Bushing	\$35.65
(9)	9710080008	Washer	\$0.75

To tighten up side to side play on water

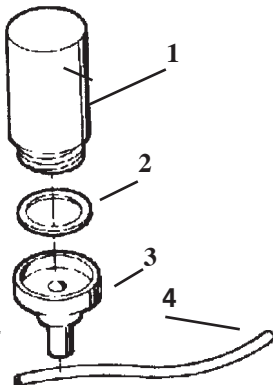
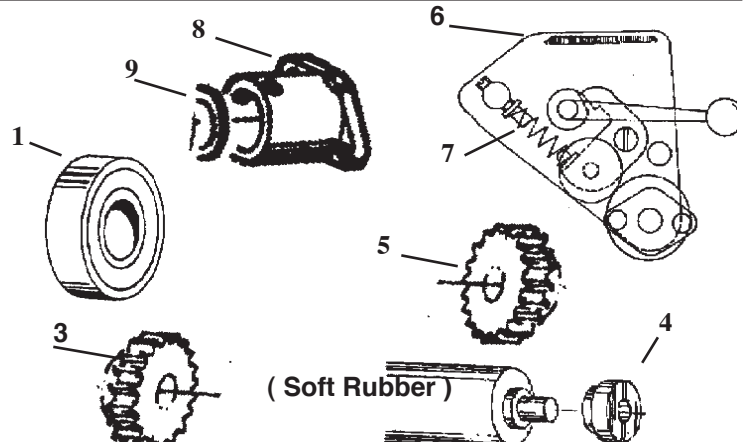

RYOBI 2800, 3200, Water Bottle Assembly & Parts

USED WATER FOUNTAIN FOR SALE PHONE

5290-53-250-2 Cap Assembly \$44.95

(1)	5290-53-251	Bottle	\$12.25
(2)	5290-53-256	Packing	\$4.25
(4)	5291-53-195-1	Hose	\$1.75

New Style Bottle Cap 3200, 3302M

5300-53-251-1	Bottle	\$54.95
5300-53-256	Packing	\$4.25
5300-53-250-1	Cap Assy	\$34.00

PRESSLINE INK ROLLER KIT

WE HAVE A SOFT RUBBER ROLLER KITS FOR

THE RYOBI MODEL 3302M AND ITEK MODEL 3985

Kit consist of 3 ink forms, 5 distributors and 1 ink ductor.

All rollers are Guaranteed For one Year.

3302/3985/9985
OPERATOR MAINTENANCE MANUAL

INK ROLLER ADJUSTMENTS

23 YEARS SELLING RYOBI
OFFSET PRESS. PRESSLINE HAS
THE LARGEST STOCK OF RYOBI
PARTS IN THE NORTH WEST.

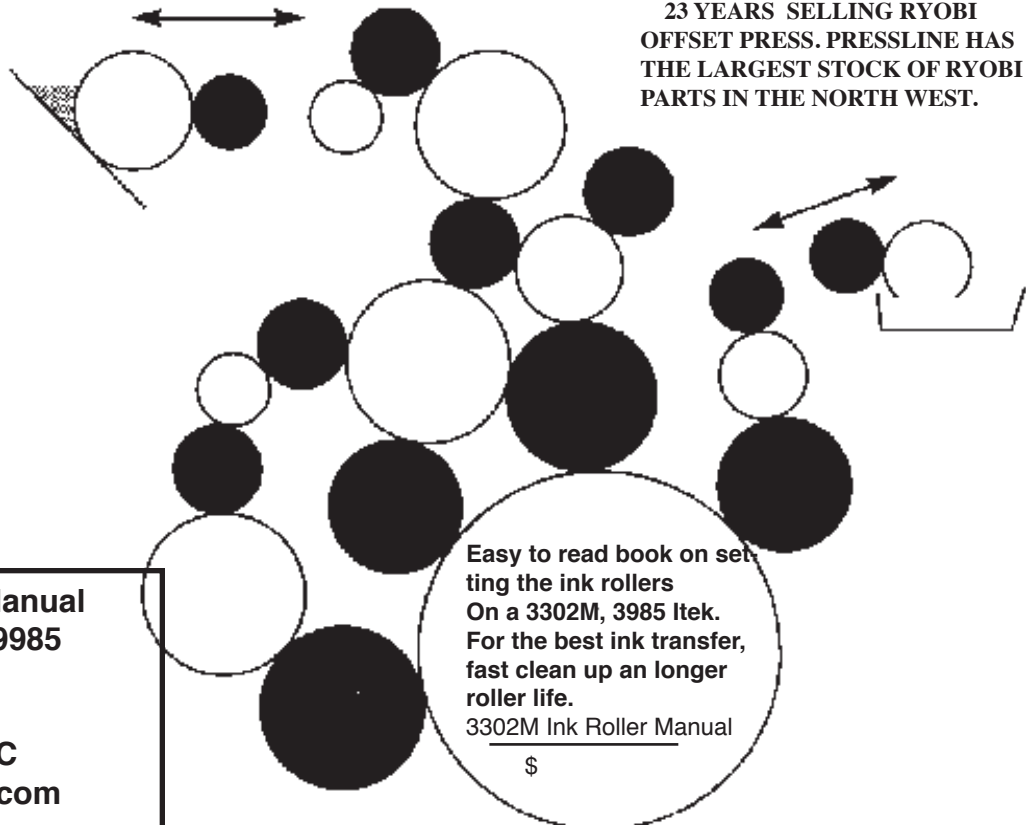

Ink Roller Adjustment Manual
For Ryobi 3302M /3985/9985
A Must to Have \$

Pressline Equipment INC
presslineonline@gmail.com

Easy to read book on setting the ink rollers
On a 3302M, 3985 Itek.
For the best ink transfer,
fast clean up an longer roller life.
3302M Ink Roller Manual
\$

New Style Water & Ink Ductor Roller has Ball Bearing Roller Shaft Parts Page 18 .

ITEK 3980 M, 3985 M, & RYOBI 3302 M

32R -KOS	(Nine soft rubber ink rolls) Old Style Ductor	\$560.00
32R - K	(Nine soft rubber ink rolls) New Style	\$559.60

Old Style Ink & Water Ductor, Bearing & gears are not included.



Fast Stack

Modular Sheet Handling System Fast Stack System allows you to build smaller stacks, making it ideal for heavy coverage jobs. Holds approximately 2 1/4" of paper. Each starter kit includes a dolly base and stack unit
Itek 975 / 985 / 3985 RYOBI

33002M
3200 / 3200MCD \$



OPTIONAL OSCILLATOR

For RYOBI 3302M ITEK 3980/ 3985 The Optional Oscillator rides on the #3 ink form to provide extra oscillating motion, helps break up ghosting patterns improve ink coverage on heavy solids. The oscillator snaps into the channel that normally holds the wash up blade and can be installed or removed in seconds. NO
Optional Osc \$

WATER BOY

The Water Boy non-refrigerated circulator the large, 5 gallon tank means less refilling water containers. The larger capacity of fountain solution also slows down the contamination process by constantly drawing the contaminates out of the pan. Currently available for presses equipped with Crestline. **AB DICK 3985 RYOBI 3302M**

WATER BOY \$



Ryobi 3302M Parts & Accessories

CONVEYOR JOGGER GUIDE SPRING Ryobi Jogger Springs

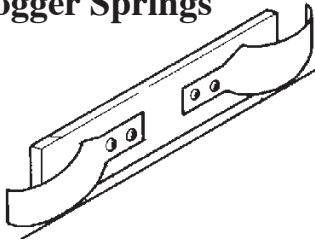

- 5341-35-882 Jogger Spring Thick Paper \$4.40
5341-35-883 Jogger Spring Thin Paper \$7.95

UNIVERSAL BRUSH SKID WHEEL ASSEM-

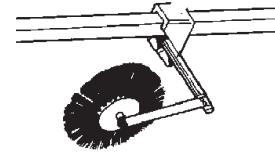
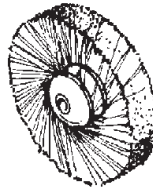

Control Register, Easy to Adjust. Work with Side Jogger, Stop Back Lash just like the Big Presses. Mount on Ryobi 3302M Roller Bracket.

AB 3985/ 9985/ Hand Crank

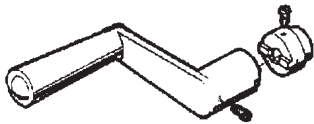

- | | | | |
|----|-------------|------------------------|----------|
| 1. | 5310-37-810 | Paper Table Crank Assy | \$226.55 |
| 1. | 5310-88-160 | Chain Table Crank Assy | \$150.00 |

NEW INK FOUNTAIN CRANK REPLACEMENT For AB Dick and Ryobi

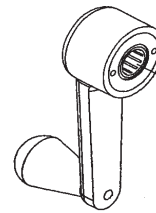

One Way Clutch Bearing

AB 3985/ 9985/ 3302M Feed Retainer

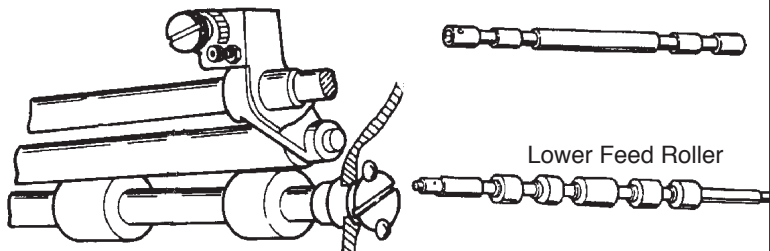

- | | | | |
|----|----------------|----------------------|----------|
| 1. | 5341-36-531Z-2 | Upper Feed Roller | \$295.95 |
| 2. | 5340-36-220-1 | Lower Feed Roller | \$173.65 |
| | 32R60 | | |
| 3. | 90352 | Bearing, Feed Roller | \$12.75 |

Parts Order

Parts for 2800, 3200, 3302M, 500N & Older Ryobi If you do not see the part you need. E-mail us a copy of your parts book with the part number you need, presslineonline@gmail.com

2700,2800,3200, RYOBİ BACK GUIDE • Chain 2800 & 3200

5290-89-146-2 Paper Guide ea. \$32.00

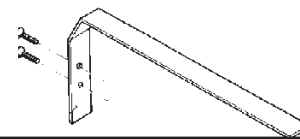

AB 9980, 3302M Gripper Bar & Chain

- | | | | |
|-----|--------------|---------------------------|----------|
| 1A. | 5310-87-3012 | Gripper Assembly Urethane | \$360.00 |
| 1B. | 5310-87-3012 | Gripper Assembly Diamond | \$ |
| 2. | 5340-87-321 | Gripper Spring | \$3.50 |
| 3. | R-90-203 | Bearing | \$7.00 |
| 4. | 5290-87-322 | Center Bracket | \$34.25 |
| 5A. | 5321-87-3182 | Gripper Finger Urethane | \$23.45 |
| 5B. | R-873182 | Gripper Finger Diamond | \$ |
| 6. | 5321-87-410 | Chain Assy | \$ |
| 6. | 87-410 | 6 Chain Links | \$ |

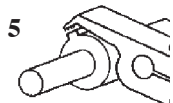

Coated Gripper
Urethane Coated
Diamond Coated

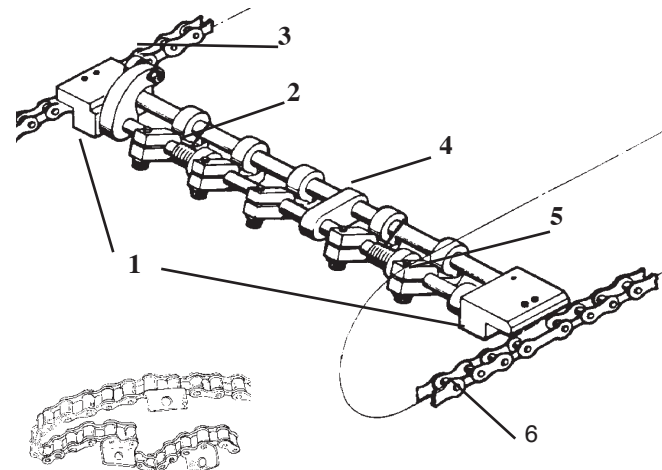

3302M Feeder Pullout Roller



**Check for Wear
Pullout Rollers
Set of Two
32R69 — — \$95.00**

- 1. 5330-35-330Z-1 Ryobi Pullout Roller 32R69 \$55.56
- 1 32R69 After Market Pullout Roller \$

For Use on all Models 3200M, Itek 3980,3985,
Precision made from high quality materials and work-
manship to produce accurate paper feeding and long
life. Synthetic rubber molded to a steel core, with
precision Torrington needle bearing.

Plate Cylinder Parts 3302M

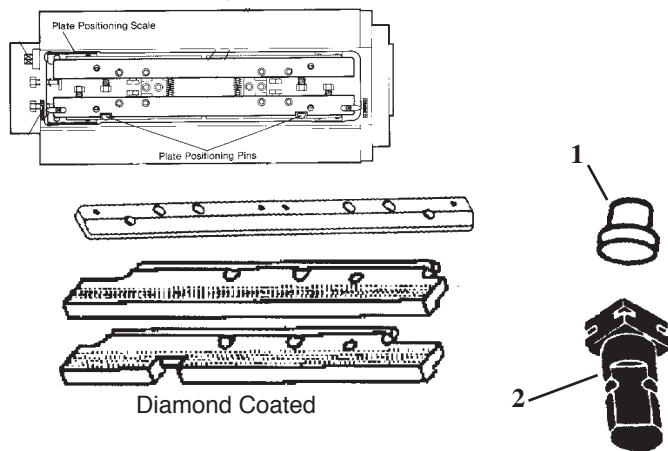

- 1A 5340-54-629 SN/6187 & Higher Pin \$7.90
- 2A. 5340-54-626-1 Lock Pin \$15.70
- 3 5290-54-338 Clamp Spring (Set of 8) \$3.25

3302M Clean Up Unit

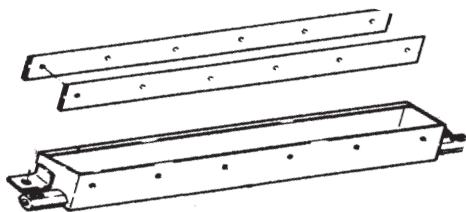

- 1. 5340-52-524-1 Clean up Blade (Set of 1) \$29.60
- 1. 5340-52-525-2 Clean up Blade (Set of 2) \$

Paper Feed Drum Gripper & Stopper

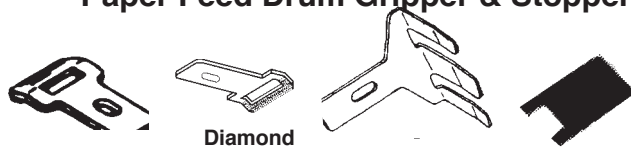

- | | | | |
|-----|--------------|------------------------------|---------|
| 1 | 5341-36-550- | Urethane Coated | \$19.90 |
| 1A. | 5341-36-550 | Diamond Coated | \$ |
| 2. | 5340-36-555 | Stopper Finger | \$8.40 |
| 3 | 964 803 0614 | Socket Bolt 3x10M (Set of 7) | \$3.40 |

3302M Feed Retainer



5341-36-315 Retainer Spring \$30.50

3302M Impression Cylinder

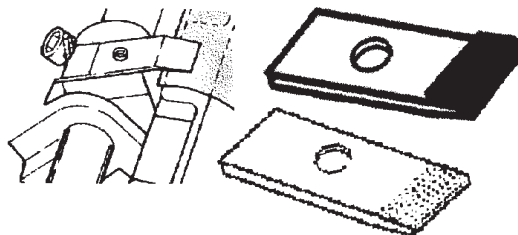

Impression Gripper

- | | | | |
|-----|----------------------------|-----------------------|-------------|
| 1 | 5340-23-240 | Urethane Coated | \$23.50 ea. |
| 1 | 5340-23-240-12 (Set of 12) | Urethane Coated | \$ |
| 1A. | 5340-23-240-D (Set of 12) | Diamond Coated | \$ |
| 2. | 9648030614 | Screw Set of 12, 3X6M | \$.045 |

Tech Sheet Sold With Installation Instructions Sheet.
Bad Impression Cylinder Register Can Be one
Urethane Gripper.
Or maybe the Adjustment was not done to Ryobi
Instruction.

Impression Cylinder Main Spring



- | | | | |
|---|-------------|-------------------|--------|
| 1 | 5340-23-233 | Impression Spring | \$9.75 |
|---|-------------|-------------------|--------|

Tip: Old springs lose some of their resistance over time and the 3302M is susceptible to Bad Register should be replaced if Press Is over 5 yr. old, Its not a big cost. Sold With Installation Instructions Sheet.

Paper Feed Board Retainer Spring 3302M



5340-35-555	For Thin Paper	\$18.00
5340-35-556	For Thick Paper	\$15.75
5340-35-557	For Thick Paper	\$27.75

3302M Drive Shaft Assy



5340-25-110-1	Drive Shaft Assy	\$261.00
R-90207	Bearing 6203LLB	\$9.50

Tip: Replacement of 3302M Drive Shaft Not Done Right Can Damage Your Impression Cylinder.

RYOBI T-51 PARTS

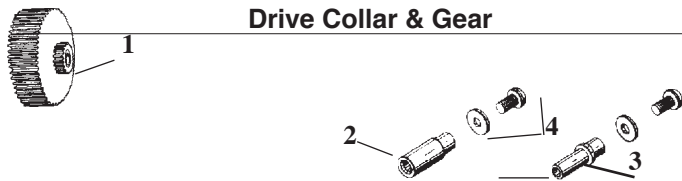

Drive Collar & Gear

(1)	38407 Drive Gear Assy	\$138.00
(2)	8411 First form Bushing Ink Roller	\$8.45
(3)	8410 Drive Gear Bushing	\$8.45
(4)	950046 Kit Screw & Washer	\$.75

Tip Ink Form Bushing 2 & 3 Bushing might look good but when there is to much wear you will get gear streak and line toning on the plate



Plate Micro Adjustment.

1	7151	Clamp	\$29.85
2	7153	Micro Screw	\$21.35
3	4152	Screw	\$8.95
4	19152	Post	\$18.25

Stop Water From Dripping on Your Printing!



Square Frame New Style

34768	Square Frame (2800)\$44.00
34768	Drip Tray (NS) (3200)\$

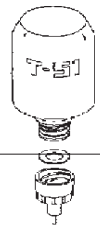

1.	3642	Bottle W/Cap Assy	\$26.00
2.	8641	Cap Assy	\$24.70
4.	19649	Water Hose	\$1.85



1570	Ink (Right) Pawl	\$15.95
1572	Ink Spring Red	\$7.45
1571	Water (Left) Pawl	\$15.95
573	Water Spring Left	\$7.45

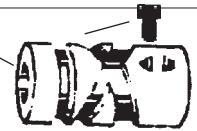

1	405-N	SET (Worm, Dog & Screw)	\$.
2.	1802	Worm New Style	\$85.50
3.	4804	Dog (NS)	\$57.80
4.	4845	Dog Spring Retainer	\$4.85
5	910016	Screw	\$0.75

Tip: Weak Spring Will Cause Dog & Worm to go out Also spin cleaning will cause dog & worm to go out

Transfer Roller Bushing & Bearing.

7826	Transfer Bushing	\$34.45
T-900002	Transfer Bearing	\$5.95



T-51 T-Wrench

No- 1132 T-Wrench \$29.95



RYOBI T- 51 USED ROLLERS & PARTS

(OLD STYLE -- 2 ink oscillators)

(T-51 Style -- 3 ink oscillators)
2800, 960, 3200, 3200MCD

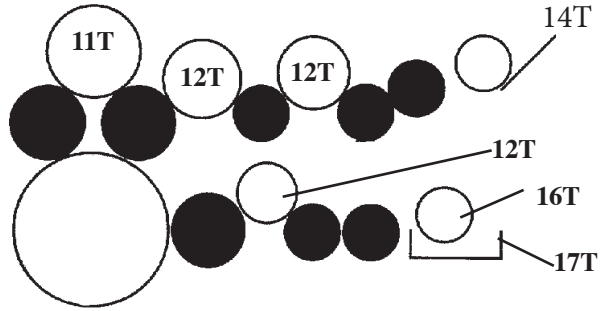
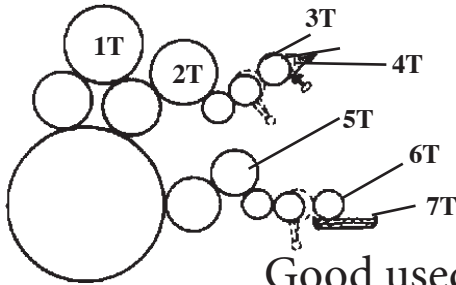

Good used Rollers in stock
For 2800,3200, AB Dick

Pressline has a good stock of used T-51 parts from presses that we exported to Mexico & India they do not have a uses for T-51 Color Heads so we just parted them out.

11T- 34823	2800 Large OSC ASSY	New	\$478.90	Used	\$225.00
12T- 34824	(3) 2800 Small OSC ASSY	New	\$420.00	Used	\$210.00
14T 34636	2800 Ink Fountain ASSY	New	\$450.75	Used	\$210.00
14T 18602	2800 Ink Fountain Roller	New	\$135.50	Used	\$55.00
16T 34601	2800 Water Fountain Roller	New	\$128.80	Used	\$55.00
17T 34651	2800 Water Fountain	New	\$134.90	Used	\$55.00

POWDER PRO

If You Need A Powder Unit That Works, The Powder Pro Is Conceded The Number One Powder Unit.



Spraying System. It is the first sprayer for small to medium sized presses. To offer true control over the amount of powder delivered to the sheet. Powder Pro uses suction, not forced air, to evenly raise the powder To a constant level in the jar. This uniform lifting the powder, regardless. Of the amount of powder in the jar, results in a extremely consistent air/ powder Mix delivered to the sheet. No Powder Pro \$ E-mail For Cost Ryobi,2800, 3200, 3302M, 3302H presslineonline@gmail.com

Go GET 'Em?.

Printing orders grow thick on trees or
Buzz around as thick as bees, you could
Sit right there in your swivel chair, hear
Your presses hum if jobs had legs and walked
Right in and greeted you with a pleasant
Grin you could sit right there in your swivel
Chair, but it is a hard degree of fact that
Printers hustle early and late so you better
Beware of that swivel chair for
Job aren't going to come right in